

# LOGISTICS & TRANSPORTS EXPO THESSALONIKI



**11-13**  
**April 2024**

**HELEXPO**  
THESSALONIKI

**THE LOGISTICS  
TRADE SHOW  
FOR THE  
BALKANS AND  
S.E EUROPE**



## THE NEW EXHIBITION FOR LOGISTICS AND TRANSPORTATION SERVICES IN THESSALONIKI

## LOGISTICS & TRANSPORTS THESSALONIKI EXPO

A new exhibition event for the logistics and transport sector is inaugurated in Thessaloniki in April 2024. The new exhibition, named "LOGISTICS & TRANSPORTS THESSALONIKI EXPO," will take place in the heart of the city at the Thessaloniki International Exhibition Centre (TIF-HELEXPO) from April 11th to 13th, attracting professionals from Greece and the Balkan countries.

The organisers, aiming to bring together neighbouring countries which regularly collaborate with each other as well as with the Northern and the rest of Greece in terms of export trade and logistics, are planning an exhibition and conference event focusing on connecting and fostering partnerships among these countries, with Thessaloniki at the centre. This initiative offers additional collaboration opportunities for companies based in Greece.

The exhibition will cover sectors such as transportation and logistics companies, ports and forwarding companies, railway and road transportation, warehouse equipment, lifting machinery, shelves and automation, information technology, as well as professional vehicles.

A significant number of businesses from Greece and the Balkan countries, chambers of commerce, professional organizations and the government have expressed interest in this new event and intend to participate, strengthening this important event to be held in Thessaloniki. The exhibition will also be complemented by the conference event LOGI.C (Logistics Conferences), established, and recognized in the market for over a decade.

### THE OBJECTIVES OF THE 1st ORGANIZATION IN NUMBERS

- 120 Exhibitors**
- 4.500 Visitors**
- 500 International Visitors**
- 8 Conference Themes (LOGI.C)**



Simultaneously, the exhibition for international trade in fruits and vegetables, "Freskon," organized by HELEXPO, will take place on the same dates, presenting the following statistics:

- 220 Exhibitors**
- 4.300 Greek & International Visitors**
- 250 hosted buyers**

## THE BENEFITS OF PARTICIPATING IN THE EXHIBITION

The LOGISTICS & TRANSPORTS THESSALONIKI EXPO provides a unique opportunity for companies offering transportation and logistics services and technologies to connect with thousands of businesses from Greece and abroad. The new era that Greece, and especially Thessaloniki, has entered with the new prospects created by infrastructure development, increased trade and exports, the strategic position of our country in Southeastern Europe, and the growing interest of investors, creates opportunities for all businesses in the industry. By participating in the exhibition, you partake in the events of our country, you affirm your presence at a leading event in Northern Greece, engage in meetings with entrepreneurs and investors from Greece, the Balkans, and Europe in general, and strengthen your corporate presence.



## GREECE'S ROLE IN THE BALKANS

The role of the supply chain and the logistics industry has been continuously improving, over the last 8 years, in our country. The sectoral participation in the formation of the GDP approaches 11-13% with increasing trends, while the high quality of services provided by Greek logistics companies, combined with the completion of significant infrastructure projects in the country, port development and the great investment interest, have placed Greece in the top 20 countries with developed logistics worldwide, in World Bank's Global Logistics Performance Index (LPI no 19), in contrast to its 49th place just three years ago.

In this context, it is evident that the economy of Northern Greece plays a significant role in the Balkans and Southeastern Europe, with Thessaloniki gradually assuming its deserved role as a Transport and Logistics Hub for the broader region. The investment initiatives for the development of ThPA, in combination with the existence of a robust supportive network (Igoumenitsa, Volos, Kavala, Alexandroupoli), and the railway and intermodal cooperation with neighbouring Balkan countries, outline a bright future for the region and the industry as a whole.

## TIF-HELEXPO EXHIBITION CENTRE

The International Exhibition Centre of Thessaloniki is located in the centre of the city, with direct connections to "Macedonia" International Airport, the road axis to the Balkans and the entire railway network of the country. It covers a total area of 180,000 sq.m., 62,000 of which constitute the covered exhibition space distributed across a complex of 17 pavilions.

With free parking for exhibitors and visitors, indoor and outdoor restaurants, ATMs, and hotels nearby to facilitate easy access to the fairground, it ensures the best possible hospitality, entertainment and accommodation services for exhibitors and visitors alike.



## EXHIBIT CATEGORIES

### 1 TRANSPORTATION SERVICES, LOGISTICS & FREIGHT FORWARDING

- ▶ International and National Transportation
- ▶ Logistics, 3PL & Warehousing Services
- ▶ Transport & Distribution Services (last mile)
- ▶ Freight Forwarders
- ▶ Road Transport
- ▶ Rail Transport
- ▶ Maritime Transport
- ▶ Air Transport
- ▶ Courier Companies
- ▶ Logistics Consultants

### 2 WAREHOUSE EQUIPMENT, AUTOMATION, COMMODITIES PACKAGING & TECHNOLOGIES

- ▶ Lifting Machinery
- ▶ Shelving and Warehouse Organization Systems
- ▶ Automation and Robotic Systems
- ▶ Information Systems (ERP, WMS, AI)
- ▶ Barcoding, Rfid, Ex-Van, Voice Picking systems
- ▶ Construction of Warehouses and Industrial Buildings
- ▶ Commodity Packaging Machinery and Materials
- ▶ Pallets, Cardboard Boxes, Racks etc.

### 3 PROFESSIONAL VEHICLES & TRANSPORTATION TECHNOLOGIES

- ▶ Professional Transport and Distribution Vehicle Dealerships
- ▶ Electric and Hybrid Professional Vehicles
- ▶ Electric Mobility Infrastructure, Chargers and Accumulators
- ▶ Leasing & Rental of Vehicles and Machinery
- ▶ Telematics, Transport Technologies & Fleet Management Systems

**Logi.C** 24  
LOGISTICS CONFERENCES

## LOGI.C CONFERENCES 2024

The LOGI.C – Logistics Conferences, in their 12th annual presence, renew their appointment with the market of freight transport, logistics, and supply chain management in Thessaloniki, as they will be held within the framework of the new LOGISTICS & TRANSPORTS THESSALONIKI EXPO exhibition, at the HELEXPO-TIF site. During a three-day multidisciplinary event, supported by the leading professional organizations of Northern Greece and collective bodies in the logistics industry, the LOGI.C conferences aim, once again, to bring together companies, executives, academics, business consultants, students, and professionals in the broader field of the supply chain, by presenting what's new in terms of trends, challenges for the future, technological changes and strategic planning for Thessaloniki and Northern Greece in general.

Several industry associations and organizations, such as SBE, SEVE, TCCI, HIT/CERTH, EEL, OFAE, Thessintec, have already expressed their positive stance in supporting and participating in the LOGI.C conferences, setting high expectations for what one can anticipate from attending the conferences.

## VISITORS PROFILE

- ▶ Commercial companies of all sectors
- ▶ Organized Retail and Wholesale Trade
- ▶ Online shops (e-shops)
- ▶ Manufacturers and industries of all sectors
- ▶ Transport companies, logistics, distribution, courier, and storage companies
- ▶ Construction companies
- ▶ Companies with fleets of distribution and transport vehicles
- ▶ Professional drivers, clerk operators and warehouse staff
- ▶ Public organizations, Local Government branches, Army Corps, Banks and Public Administration
- ▶ Professors, Business Consultants, Students

## ADVERTISING ACTIVITIES

Through dynamic advertising promotion in Greece and abroad, the LOGISTICS & TRANSPORTS THESSALONIKI EXPO exhibition will convey a powerful communication message through a blend of advertising.

-  ▶ **DIGITAL ADVERTISING**  
Websites, newsletters, social media, Google Ads & mass SMS, in Greece and abroad
-  ▶ **PRINTED ADVERTISEMENT**  
In international magazines of 8 countries
-  ▶ **VISITORS' INVITATIONS**  
Printed and online Invitations in Greece and abroad
-  ▶ **TELEVISION**  
Advertising spots on nationwide channels
-  ▶ **RADIO**  
Advertising spots on high rating stations all over the country



## HALL 10

## HALL 9

## HALL 8

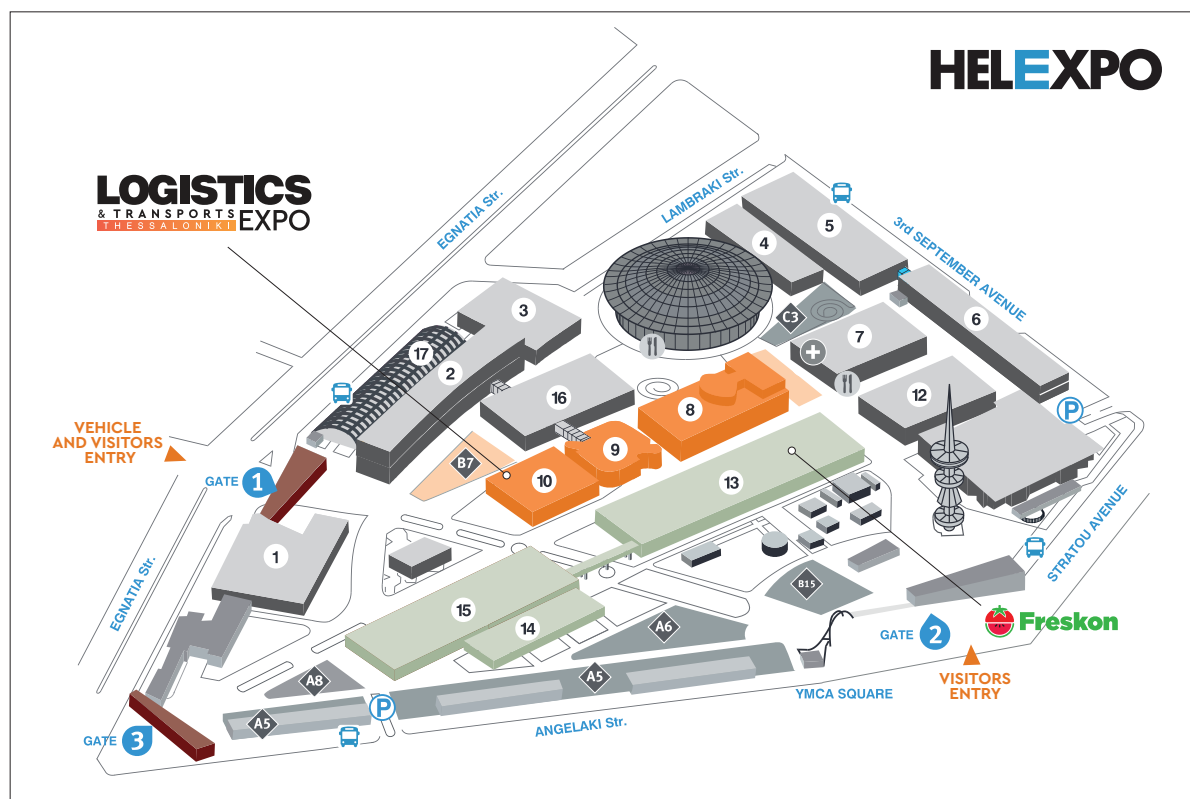
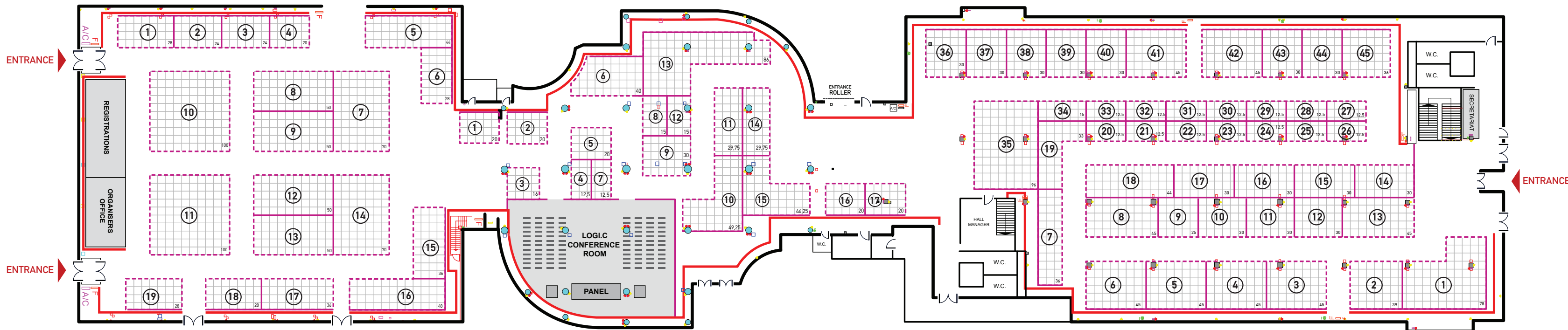

### OPERATING HOURS

**THURSDAY**  
APRIL 11<sup>TH</sup> ..... 10:00-19:00

**FRIDAY**  
APRIL 12<sup>TH</sup> ..... 10:00-19:00

**ΣΑΒΒΑΤΟ**  
APRIL 13<sup>TH</sup> ..... 10:00-18:00

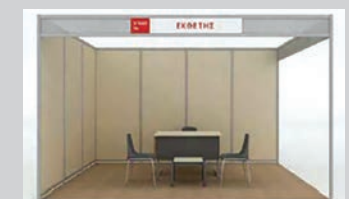

**BASIC STRUCTURE 25€/m<sup>2</sup>**

- Beige panel dividers with beige carpet
- 1 desk
- 3 grey chairs
- Structure Fascia
- 5 LED lamps on a rail
- 1 power socket 500W

### PRE-DESIGNED EXHIBITION BOOTH SOLUTIONS



**BASIC\_MINIBOOTH 35€/m<sup>2</sup>**

- FLOOR:** Beige coloured Alma carpet. **STRUCTURE:** Octanorm aluminium system (H: 2.50m). **PANELING:** Black leatherette panels. **SIGN:** Beech melamine 1.20 x 0.35m with exhibitor's brand name on self-adhesive vinyl. **EQUIPMENT:** Infodesk black, 1 pc. • Black stool, 1 pc. • Beech table, 1 pc. • Gray chairs, 3 pcs. **POWER SUPPLY:** Socket 500W 2 positions, 1 pc. • 5 Led lamps on a rail, 2 pcs.



**BASIC\_PLUS 55€/m<sup>2</sup>**

- FLOOR:** Black coloured Alma carpet. **STRUCTURE:** Octanorm Maxima aluminium system (H: 2.50m). **PANELING:** Panels of white & black leatherette. **CEILING:** 1.00 x 1.00m Aluminium frame with white panelling. **SIGN:** 1.50 x 0.30m white melamine with the exhibitor's brand name on self-adhesive vinyl. **GRAPHICS:** Digital printing on framed tarpaulin 2.05 x 1.00m, 1 pc. **EQUIPMENT:** Infodesk black, 2 pcs. • Black stool, 2 pcs. • Glass table, 1 pc. • Black chairs, 4 pcs. **POWER SUPPLY:** 2 position socket 500W, 2 pcs. • 50W Led floodlights, 6 pcs.



**EXECUTIVE 65€/m<sup>2</sup>**

- FLOOR:** Grey coloured Alma carpet. **STRUCTURE:** Octanorm Maxima aluminium system (H: 2.50m). **PANELING:** Panels of white leatherette. **STORAGE:** 1x1 with opening door. **SIGN:** White PVC 0.90 x 0.35m with digital printing. **LIGHT BOX:** Milky plexi glass / int. lighting dimensions 2.00x3.00m. **GRAPHICS:** Digital print 1.00 x 2.50m., 1 pc. **EQUIPMENT:** Infodesk white (lacquered) 0.70 x 0.55 x 1.00m, 1 pc. • Black stool, 1 pc. • Glass table, 1 pc. • Black chairs, 4 pcs. **POWER SUPPLY:** 2 position socket 500W, 2 pcs. • Led projectors 100W, 6 pcs.



**PREMIUM 95€/m<sup>2</sup>**

- FLOOR:** White melamine. **STRUCTURE:** Wooden mdf construction in white colour (H: 3.00m). **STORAGE:** 1x1 with opening door. **SIGN:** White pvc 1.20 x 0.40m with digital printing. **LIGHT BOX:** Tarpaulin / int. lighting, dimensions 3.80 x 2.80m. • Tarpaulin / inner lighting, dimensions 2.80 x 2.80m. **EQUIPMENT:** Infodesk white (lacquer) 1.20 x 0.55 x 1.00m, 1 pc. • Stool white, 1 pc. • Glass table, 1 pc. • White chairs, 4 pcs. **A/V EQUIPMENT:** 42" TV (with floor stand). **POWER SUPPLY:** 2 position socket 500W, 2 pcs. • Led projectors 100W, 3 pcs.

### BOOTH RENTAL COST

Free Structure (ground trace price)

- ▶ One side open: ..... 125 €/m<sup>2</sup>
- ▶ Two sides open: ..... 130 €/m<sup>2</sup>
- ▶ Three sides open: ..... 140 €/m<sup>2</sup>
- ▶ Open air space: ..... 65 €/m<sup>2</sup>

### ADDITIONAL CHARGES

- ▶ Basic structure pack: ..... 25€/m<sup>2</sup>
- ▶ Carpet: ..... 5€/m<sup>2</sup>
- ▶ Booth Divider Panels: ..... 20€ per running meter
- ▶ Registration in the exhibitors' catalogue: ..... 200€\*

Prices are subjected to VAT.  
\* It includes registration in the official catalogue of the Exhibition as well as digital display of each exhibitor's participation.

Space Rental & Construction Price Package

**12,5 m<sup>2</sup> / 2.200€\***

Prices are subjected to VAT.

\*Structure Packages include the rental of the space, the listed type of construction, the registration in the exhibitors' catalogue, the digital display of the exhibitors on the exhibition's social media and the promotion through the Supply Chain & Logistics magazine.

Space Rental & Construction Price Package

**30 m<sup>2</sup> / 4.950€\***

Space Rental & Construction Price Package

**30 m<sup>2</sup> / 5.500€\***  
**45 m<sup>2</sup> / 8.500€\***

Space Rental & Construction Price Package

**30 m<sup>2</sup> / 6.600€\***  
**45 m<sup>2</sup> / 9.700€\***



## THE ORGANISING COMPANY

O.MIND CREATIVES, with 20 years of stable and successful track record, is active in the highly demanding field of organizing exhibitions and conference events, as well as publishing sector-specific materials. With a staff of experienced executives and established partners and an outward orientation, O.MIND CREATIVES ensures the successful organization of LOGISTICS & TRANSPORTS Thessaloniki EXPO.

O.MIND CREATIVES has a track record of highly successful business initiatives, including the organization of international exhibitions and conferences in the logistics, transportation, and professional vehicle sectors, as well as in the food industry. They have been organising the successful exhibition SUPPLY CHAIN & LOGISTICS, in Athens, since 2007, as well as the CARGO TRUCK & VAN EXPO and the MEAT/DAIRY/FROZEN FOOD exhibitions.

As a publishing company, O.MIND CREATIVES releases industry-specific magazines such as SUPPLY CHAIN & LOGISTICS, MEAT PLACE, GRILL MAGAZINE, and DAIRY NEWS, provides online information through four highly visited websites, and manages a large number of informative social media accounts. All these elements of its activity place it among the top 5 companies in Greece in the field of exhibition organization, according to a recent industry study by ICAP.



187, SYNGROU AVENUE, 171 21 NEA SMYRNI, ATHENS  
T +30 210 90 10 040 | F +30 210 90 10 041  
info@omind.gr | [www.omind.gr](http://www.omind.gr)

# LOGISTICS & TRANSPORTS EXPO

THESSALONIKI

**11-13**  
**APRIL**  
**2024**  
**HELEXPO**  
THESSALONIKI

> Concurrently, the  **Freskon** exhibition will also be taking place.

## OPERATING HOURS

**THURSDAY**  
APRIL 11<sup>TH</sup> ..... 10:00-19:00  
**FRIDAY**  
APRIL 12<sup>TH</sup> ..... 10:00-19:00  
**SATURDAY**  
APRIL 13<sup>TH</sup> ..... 10:00-18:00

[www.logistics-expo.gr](http://www.logistics-expo.gr)